

Monoflo Universal Parts





Monoflo is a leading name in the design, manufacture and supply of progressing cavity pumps, parts, grinders, screens and packaged solutions, worldwide. We have 8 international sites and a global distribution network, as well as 75 years' experience in providing a range of products for the multiple application requirements of today's industries.



Monoflo Universal Parts

Monoflo has a reputation for quality in both equipment and parts. Over recent years it has been our mission to use our manufacturing and engineering expertise to expand our product offering to include high quality parts for other brands of progressing cavity (PC) pumps.

As such, all Monoflo Universal Parts attract the same warranties and guarantees as parts for Monoflo pumps.

Availability

Comprehensive stocks of parts and complete replacement pumps are held in the Monoflo office in Houston, Texas. This offers best in class lead times, minimal downtime and eliminates the need for you to hold extensive stocks.

Same day delivery is available on request for stock items, to ensure minimum disruption and production downtime. This industry leading service combined with competitive pricing gives you a trusted and valued source when buying your spare parts.

Competitive Pricing

With an increasing focus on operational and maintenance cost control, we understand that the price and availability of spare parts is high on the agenda when evaluating plant savings and efficiencies.

Using our global manufacturing facilities and leveraging our engineering know-how, we are able to produce Monoflo Universal Parts at highly competitive prices. Typically we can offer customers a saving of up to 40%.

Quality Assurance

We are in a unique position to closely control the quality and integrity of our parts as we manufacture all the key components of a PC pump in-house. This ensures they are dimensionally accurate, of the correct material specification and offer optimum performance for your equipment.

Product Portfolio

Please see below the most common ranges we cover, usually from stock. For others not listed, please contact Monoflo.

	Moyno®	seepex®	Netsch®	PCM	Allweiler	Bornemann
PUMP RANGES	2000 Series 1000 Series L Frame	BN NS BT MD	NEMO® NM® NE® NU	I and ID IVA and IDVA MR/MV-I and ID	TECFLOW AE SN SH SZ	E Range
GEOMETRY		Std (standard) -L (long pitch) -T (2/3)	S (standard) L (long pitch) P (2/3 long)		Std (standard) TECFLOW (2/3)	

We can supply:

- Rotors
- Stators
- Coupling rods
- Shafts
- Pins/bushes
- Seals
- Drive train assemblies
- Gear joints

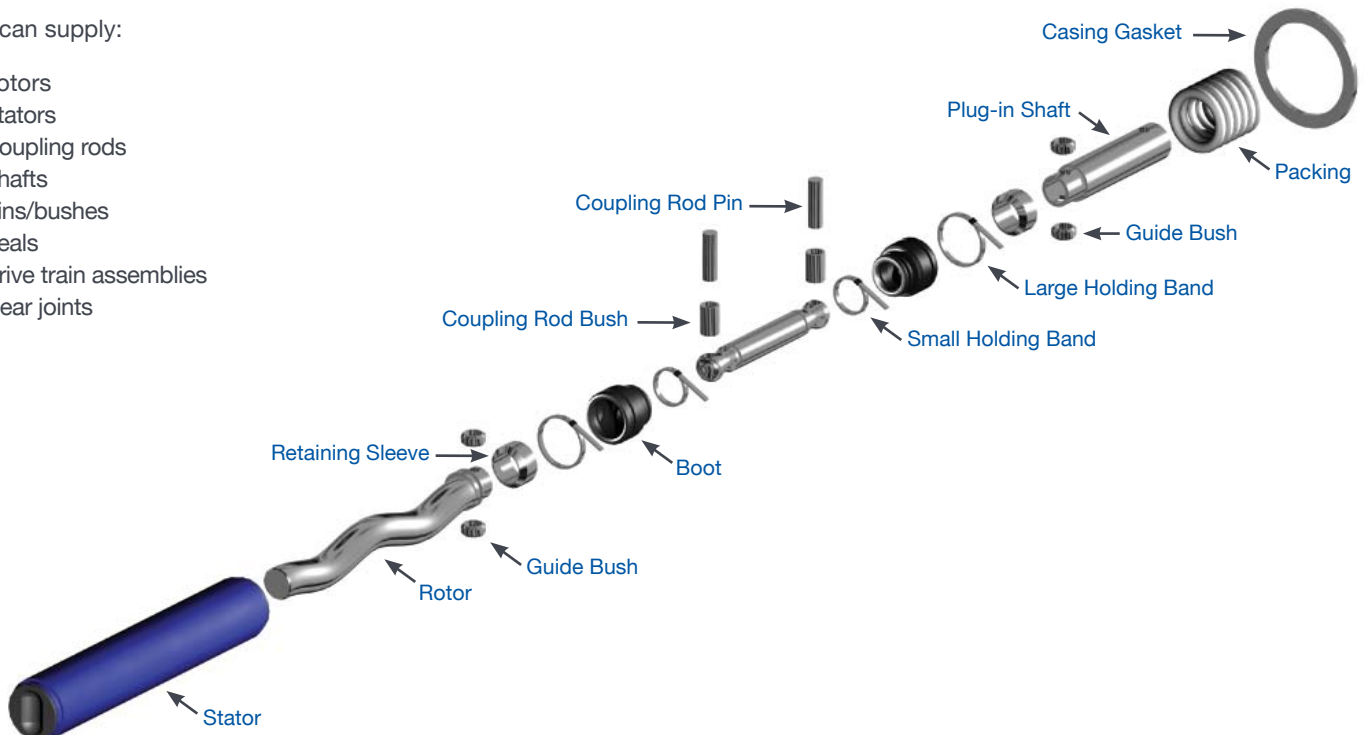

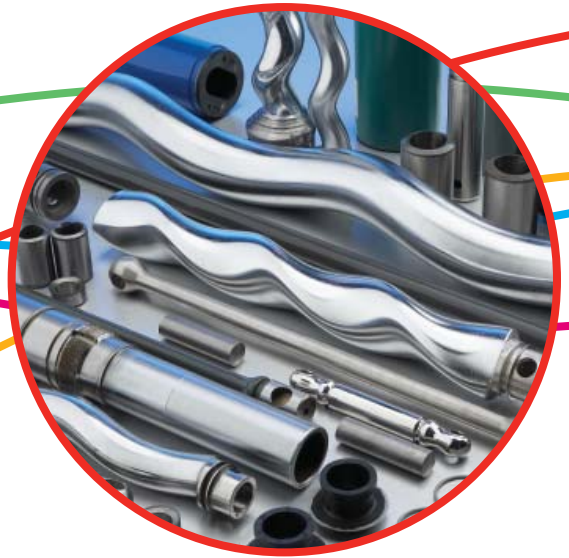

Rotating Assembly

On selected ranges, we can offer our customers fully assembled rotating units. This value adding service assists you in reducing your operational expenditure as it reduces assembly and installation time on site and gives cost savings by purchasing the complete unit rather than the individual components.

The following items are all included in the rotating unit:

- Rotor
- Stator
- Joint kit
- Coupling rod
- Plug in shaft
- Mechanical seal or gland packing

Please contact the Monoflo Universal Parts team to find out more.

Pump Replacement

Often the cost of replacing spare parts from other PC pump manufacturers can be extremely expensive. In some instances you can purchase a Monoflo progressing cavity pump for the same price or even less than the price of spares from your supplier.

We also have in stock complete replacement pumps when the cost of parts, combined with your labor, exceeds the total pump price, but piping changes are not an option.

Pumps from our ML Series and XL Series are fully assembled and ready to ship to replace your L Frame or 2000 Series pumps from Moyno®.

Support

Our team of experienced application and sales engineers have a wealth of industry and product knowledge to assist you in correct product selection, problem solving and aftermarket support.

Our promise is clear ... one company, unlimited solutions.

Contact the Monoflo Universal Parts team on:

T. 281 272 7745

F. 281 272 7792

E. veronica.alvarez@nov.com or inquiry@monoflo.com



The Facts

Monoflo Universal Parts

1. Monoflo Universal Parts attract a three year warranty against defective materials and manufacture.

2. Monoflo will adopt the balance of asset warranty when Monoflo Universal Parts are fitted.*

3. All Monoflo Universal Parts are manufactured to ISO9001:2000.

4. Rotors are plated to a thickness of .010" (0.25mm) hard chrome plating as standard.

5. Stators are produced from fine tolerance tubing and custom developed elastomers to produce a long lasting quality second to none. Monoflo has developed its stator manufacturing process and elastomer compounds over 50 years of R&D, providing class leading wear characteristics and durability.

6. Multiple matrix testing has been conducted to ensure that Monoflo Universal Parts meet or exceed the performance of the original equipment manufacturer.

7. Monoflo holds close to a million dollars in inventory at our Houston facility, enabling us to operate 'Best in Class' lead times.

*Subject to duty and application confirmation.



Americas

Monoflo NOV, 9700 West Gulf Bank
Houston, Texas 77040, USA
T. +1 281 272 7700
E. inquire@monoflo.com

Monoflo S.A., Ing Huergo 2239
(1842) Monte Grande
Pcia. de Buenos Aires, Argentina
T. +54 11 4290 9940/50
E. info@monoflo.com.ar

Monoflo Canada, 5702 63rd Ave
Alberta, Lloydminster
T9V0Y4, Canada
T. +1 780 875 5504
E. info.monoflo@nov.com

Europe

Mono Pumps Ltd, Martin Street, Audenshaw
Manchester, M34 5JA, England
T. +44 (0)161 339 9000
E. info@mono-pumps.com

D.M.I EST, 56, rue du Pont
88300 Rebeuville, France
T. +33 (0)3 29 94 26 88
E. dmi-est@dmi-est.fr

Australasia

Mono Pumps (Australia) Pty Ltd
Mono House, 338-348 Lower Dandenong Road
Mordialloc, Victoria 3195, Australia
T. 1800 333 138
E. ozsales@mono-pumps.com

Mono Pumps (New Zealand) Ltd
PO Box 71-021, Fremlin Place, Avondale
Auckland 7, New Zealand
T. +64 (0)9 829 0333
E. info@mono-pumps.co.nz

Asia

Mono Pumps Ltd, No. 500 YaGang Road
Lujia Village, Malu, Jiading District
Shanghai 201801, P.R. China
T. +86 (0)21 5915 7168
E. monoshanghai@nov.com

Published information other than that marked CERTIFIED does not extend any warranty or representation, expressed or implied, regarding these products. Any such warranties or other terms and conditions of sales and products shall be in accordance with Monoflo's standard terms and conditions of sale, available on request.

Monoflo® products are marketed outside North America under the mark Mono®.

© Monoflo August 2009 Literature reference: MFI-Universal

Monoflo® is a registered trademark of Mono Pumps Ltd. seepex® is a registered trademark of Seeberger GmbH + Co. NETZSCH®, NEMO®, NM® and NE® are registered trademarks of NETZSCH Mohnpumpen GmbH. Moyno® is a registered trademark of Robbins & Myers Inc. Monoflo is not an authorised distributor of parts and services for the products of Seeberger GmbH, Allweiler, NETZSCH Mohnpumpen GmbH, PCM, Moyno and Bornemann and Monoflo products are not associated with, endorsed by, or sponsored by these companies.

www.monoflo.com

